



UltraSlide 3602



The Most Powerful & Versatile
Top Slide Surgical Table in the Industry

Advancing the Leadership in Top Slide Surgical Table Performance

At Skytron, we understand the complex demands of today's OR. Efficiency, increased throughput and cost reduction are just a few of the things you must achieve, all while delivering a higher standard of patient care and safety.

Skytron's UltraSlide 3602 table is uniquely designed to address each of your OR's needs. Its industry-leading 23 inch top slide allows you to easily move patients through the imaging window and pre-programmed positioning options allow for quick table set-up at any point during the procedure. Full body imaging can be accomplished without making risky patient maneuvers, making the UltraSlide 3602 a safe and easy to use solution. The 1000 lb. lift and 800 lb. articulation capacity is never compromised by top slide, meaning that your OR can more efficiently support a greater variety of procedures.

You can also count on the UltraSlide 3602 for long-standing reliability. Skytron tables are consistently rated as having the industry's lowest annual service costs, allowing you to rest assured that the table will keep your OR running smoothly for years to come. The UltraSlide 3602 delivers reliability without the inflated maintenance costs, all while addressing everything critical to your OR: efficiency, throughput, and most importantly – your patient.



* C-Arm courtesy of Philips Medical Systems

23 inch Top Slide Range at the Touch of a Button!



9-1/2 inch Slide-to-Head for Full **Upper Body** Imaging



13-1/2 inch Slide-to-Foot for Full **Lower Body** Imaging

Removable Back and Leg Sections Enhance Imaging Flexibility



Removable Back Section



Removable Leg Section



Power Beach Chair Shoulder Positioner
Reduces Patient Sit Time
(with Back Section Removed)



Urology Set-Up Provides
Optimal Patient Access
(with Leg Section Removed)

Additional clinical benefits of removable back and leg sections include improved anesthesia access to shorter patients in lithotomy position and enhanced leg room for seated surgeons. Lower table heights are also more easily achieved by removing vs. lowering the leg section, thereby eliminating any articulation conflicts with the floor.

Set-Ups for Specialty Procedures & Auto Beach Chair Function



Removal of the back section provides convenient attachment of the Power Beach Chair Shoulder Positioner which takes the work out of positioning patients for shoulder arthroscopy procedures.



Removable leg section permits surgeons more leg room, lower table height positioning for Urology, Cysto/Gyn, as well as enhanced imaging capabilities for Vascular and other lower body procedures.

Feature for Feature the Most Powerful and Versatile Full F

1,000 lb. Lift & 800 lb. Articulating Capacity

Head section can be used as a foot extension during transfer.

Radiolucent top permits clear, sharp image amplification.

Adjustable head section can be extended to accommodate taller patients.

Full width quick-release bar on manually operated head section is easy to locate in emergency situations.

Exclusive removable back section allows for optional 40 inch Carbon Fiber Back/Leg Section attachment.

Built-in power kidney bridge provides an additional 6 inches of lift.



Return-to-Level & Automatic Beach Chair Functions

Durable one-touch, back-lit pendant controls all functions from any point around the perimeter of the table.

The Emergency Shut Off Switch is located under the table top near the pendant control connector.

Back-up controls for emergency situations.

Recharge port

Narrow base design provides toe space clearance to eliminate surgeon back strain.



Battery life/diagnostic indicator.



Easy to use clip style power cord.



Secondary function switches for backup to primary control.

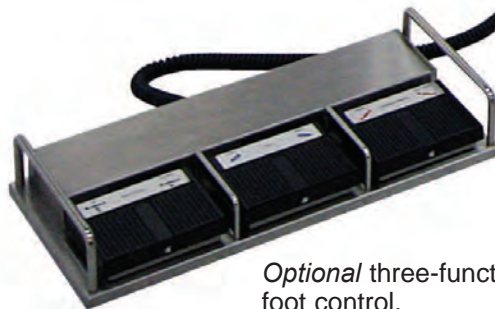

Optional three-function foot control.



42-1/2 inch Max.
24 inch Min.
Table Height



90° Reflex



40° Flex



Leg Up 15°



100° Leg
Down



90° Back Up

Function, Top Slide Surgical Table in the Industry!

Exclusive 23 inch Top Slide

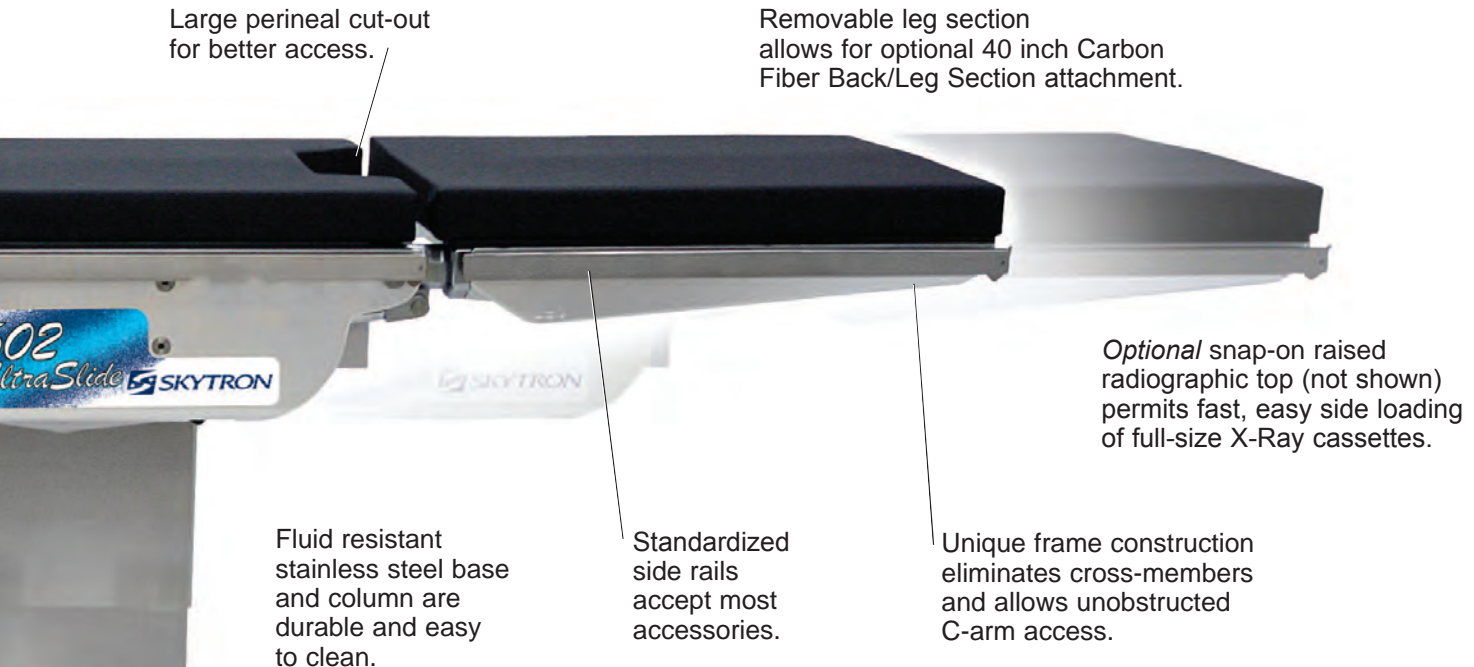

Removable Head, Back and Leg Sections

24 inch Low Table Height

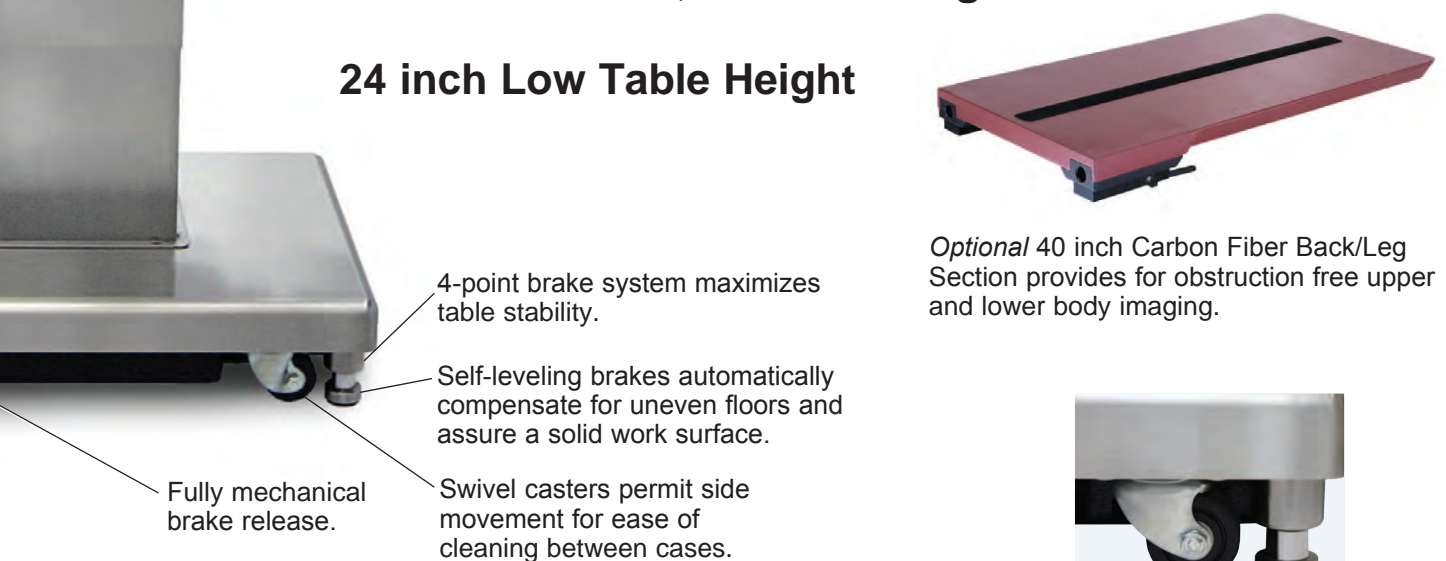

Self leveling brakes for stability on uneven floors.



40° Back Down



30° Trendelenburg & Reverse Trendelenburg



30° Lateral Tilt Right & Left



23 inch Top Slide



Beach Chair

Durable Back-Lit, One Touch Pendant Control

It's simply the easiest and most durable pendant to use from any location around the surgical table, with convenient back-lighting for high visibility when working in low light environments.

- Simple One Touch Operation
- Back-Lit Control for High Visibility in Low Lighting
- Audible Alarm for Kidney Bridge/Back Up Articulation
- Anatomically Correct Return-to-Level
- Anatomically Correct Beach Chair Position
- Recessed Buttons to Eliminate Accidental Activation
- Exceptionally Durable, Water Resistant
- Can be used in conjunction with optional Three Function Foot Control



UltraSlide 3602 Positioning Guidelines



Upper Body Imaging



Lower Body Imaging



**Upper Body Imaging
with 40 inch Carbon Fiber Extension**



**Lower Body Imaging
with 40 inch Carbon Fiber Extension**



Neuro (Neck)



Neuro (Lumbar)

UltraSlide 3602 Positioning Guidelines



Lap Nissen



Urology



Ophthalmic / ENT



Kidney / Thoracic



Shoulder Arthroscopy

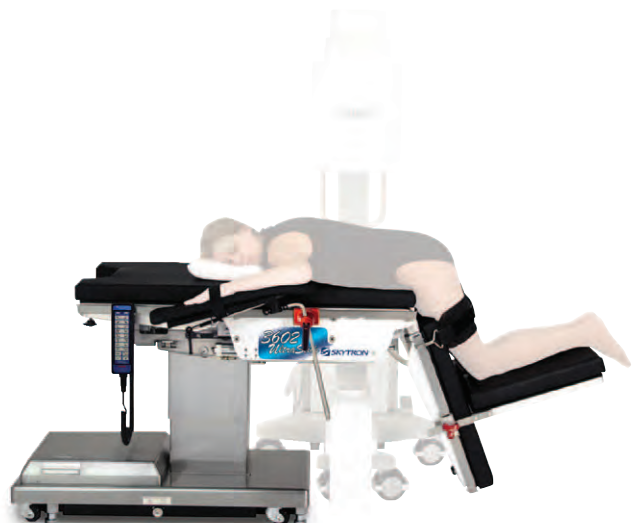

Lumbar

UltraSlide 3602 Bariatric Positioning Guidelines



Abdominal



Gastro / Intestinal



Ophthalmic / ENT



GYN / Endourology / Cystoscopy

UltraSlide 3602

Surgical Table Specifications

Technical Specifications:

Length w/o head rest	69 inch	1750mm
Length with head rest	82 inch	2080mm
Width	19½ inch	500mm
Width with side rails	22 inch	560mm

Adjustments via pendant control:

Height	24-42½ inch	610-1080mm
Lateral tilt (left/right)	30°	
Trendelenburg	30°	
Reverse Trendelenburg	30°	
Power Kidney Bridge	5¾ inch	145mm Lift
Back up/down	90°/40°	
Leg down	15°/100°	
Return to level (anatomically correct return to horizontal position from articulated positions)		
Top slide/head	9½ inch	240mm
Top slide/foot	13½ inch	340mm
Flex/Reflex	40°/90°	
Base braking (lock/unlock)		
Beach Chair		

Adjustments via manual control:

Head Section	60° up / 90° down
--------------	-------------------

Weight of operating table	800 lb. (365kg)
---------------------------	-----------------

Maximum permissible load:	1000 lb. (455kg) Lift
	800 lb. (365kg) Articulation



Full function, electrohydraulic battery powered surgical table features 23 inch (585mm) longitudinal top slide, 1000 lb. (455kg) lift and 800 lb.(365kg) articulation capacity. Table is equipped with a removable 15 foot (457cm) power cord for battery charging. Four (4) conductive casters, four point braking system with push button operation including manual override for safety and stability. Hand held, back-lit pendant control includes steel housing design providing extreme durability. Pendant permits control at any point around table's perimeter.



Privately Held, Value Focused
and a Brand Promise That Delivers.

This brochure contains information intended to illustrate a Skytron product. For questions about the availability of Skytron products in your area, contact your Skytron representative. All Skytron products are subject to change without prior notice.



5085 Corporate Exchange Blvd. SE • Grand Rapids, MI 49512
1-800-SKYTRON (759-8766) • email: sales@skytron.us

Local Representative

MAR-D-0057 REV0 5/13
PN L2-010-78